

NOTICE OF PROPOSED GRANT OF MINING CLAIMS

NATIVE TITLE ACT 1993 (CTH) SECTION 29

The Queensland Minister for Resources, PO Box 15216, City East, Queensland, 4002, hereby gives notice in accordance with section 29 of the *Native Title Act 1993* (Cth) of the proposed grant of Mining Claim (MC) shown below, subject to provisions of the *Mineral Resources Act 1989* (Qld).

MC 300438 applied for by Shayne James Roy McNeley, over an area of 15.81 ha, centred approximately 3.6 km south east of Rubyvale, in the locality of the Central Highlands Regional Council.

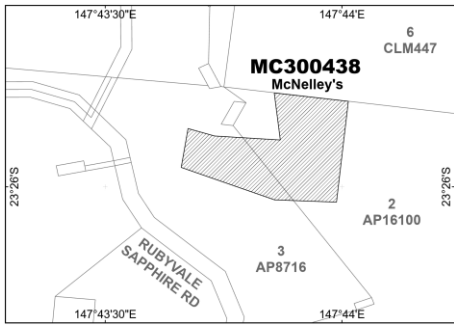

MC 300439 applied for by Bradley James Heron, over an area of 900m², centred approximately 2 kms north west of Rubyvale, in the locality of the Central Highlands Regional Council.

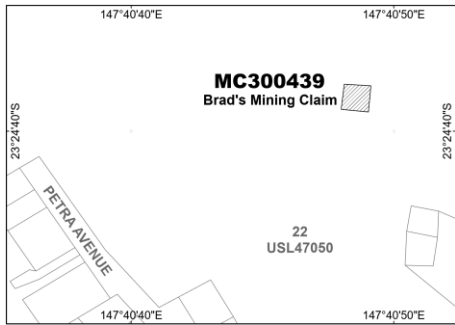

MC 300440 applied for by Glen H Knott, over an area of 890m², centred approximately 4 kms west of Rubyvale, in the locality of the Central Highlands Regional Council.

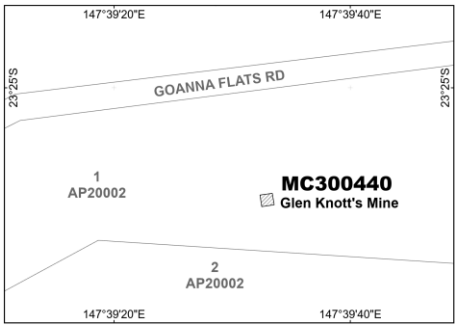

MC 300442 applied for by Coral Maree King, over an area of 880m², centred approximately 4 km west north west of Rubyvale, in the locality of the Central Highlands Regional Council.

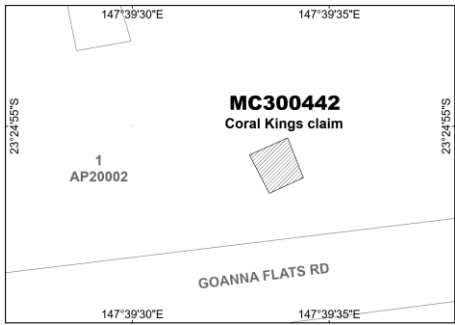

MC 300444 applied for by Amber Louise Betteridge, over an area of 900m², centred approximately 4.6 km west north west of Rubyvale, in the locality of the Central Highlands Regional Council.

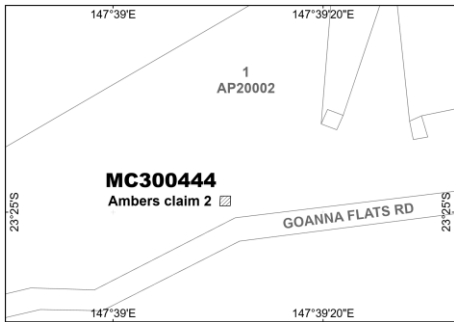

MC 300447 applied for by Nigel Jonathan Monteith, over an area of 858m², centred approximately 4.3 km west north west of Rubyvale, in the locality of the Central Highlands Regional Council.

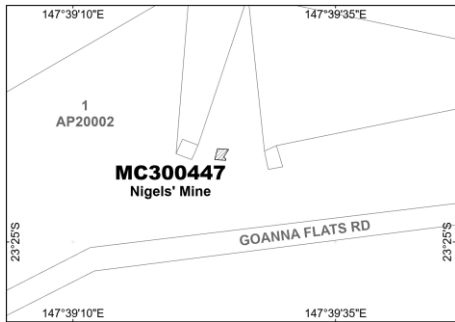

MC 300450 applied for by Naseeb Norman Jeha, over an area of 652m², centred approximately 4 km west north west of Rubyvale, in the locality of the Central Highlands Regional Council.

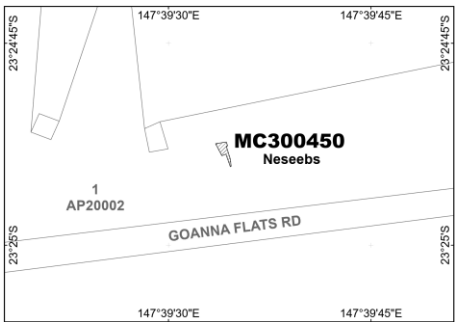

MC 300452 applied for by Katelyn Annette Wagner, over an area of 900m², centred approximately 1.8 km north east of Sapphire, in the locality of the Central Highlands Regional Council.

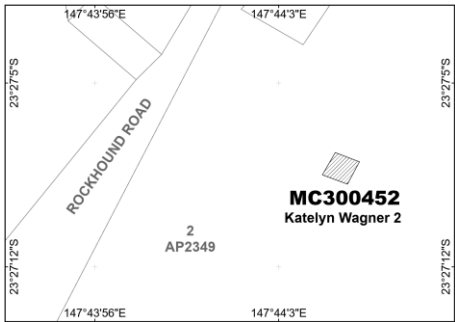

MC 300453 applied for by Joshua Jacob Millerick, over an area of 900m², centred approximately 1.5 km north west of Rubyvale, in the locality of the Central Highlands Regional Council.

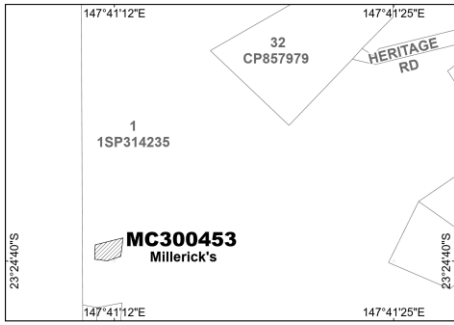

MC 300455 applied for by Shayne Donald Heron, over an area of 900m², centred approximately 2.1 km north west of Rubyvale, in the locality of the Central Highlands Regional Council.

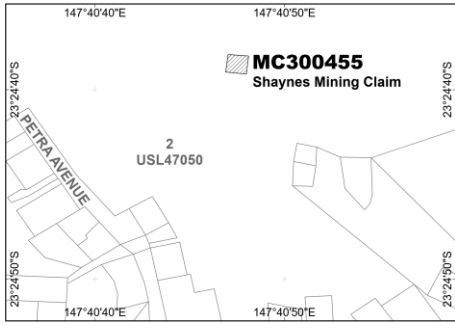

MC 300459 applied for by David Roy Walter Moore, over an area of 870m², centred approximately 4 kms west north west of Rubyvale, in the locality of the Central Highlands Regional Council.

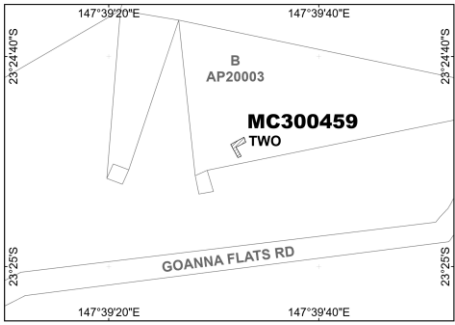

MC 300461 applied for by Rachael Jan Knipe (50%) and Rodney James Bradshaw (50%), over an area of 900m² centred approximately 4 km west of Rubyvale, in the locality of the Central Highlands Regional Council.

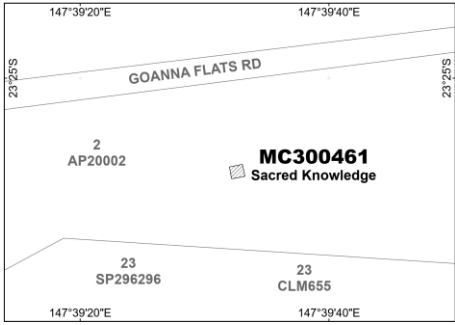

MC 300462 applied for by Dawn Maria Favaloro (50%) and Brett William Favaloro (50%), over an area of 900m² centred approximately 4 km west of Rubyvale, in the locality of the Central Highlands Regional Council.



MC 300464 applied for by Kara-Rose Carruthers, over an area of 900m², centred approximately 4 km west of Rubyvale, in the locality of the Central Highlands Regional Council.



MC 300465 applied for by Steven James Ballin, over an area of 800m², centred approximately 2.2 km north east of Sapphire, in the locality of the Central Highlands Regional Council.

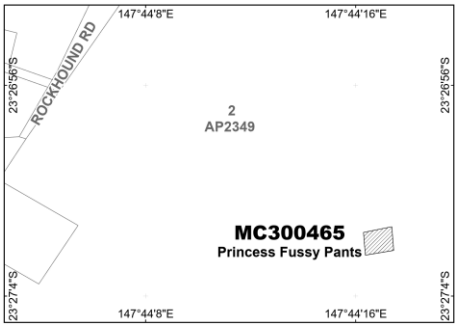

MC 300466 applied for by Phillip Gerard McNeill, over an area of 900m², centred approximately 4.1 km west of Rubyvale, in the locality of the Central Highlands Regional Council.

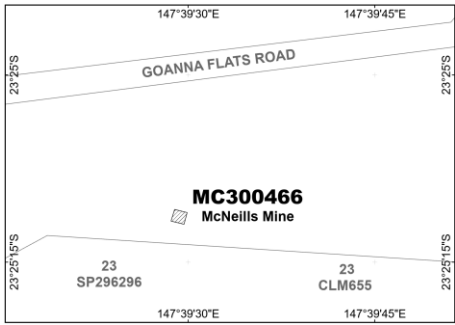

MC 300467 applied for by Kara-Rose Carruthers, over an area of 900m², centred approximately 4.2 km west of Rubyvale, in the locality of the Central Highlands Regional Council.

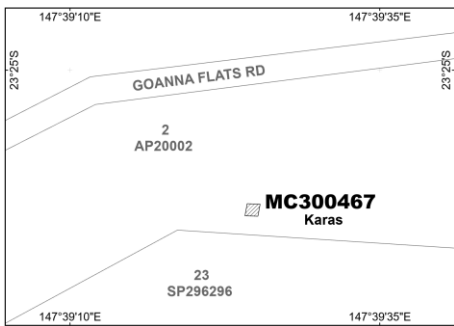

MC 300473 applied for by Bryan Henry Braunberger, over an area of 813m², centred approximately 1.4 km north west of Rubyvale, in the locality of the Central Highlands Regional Council.

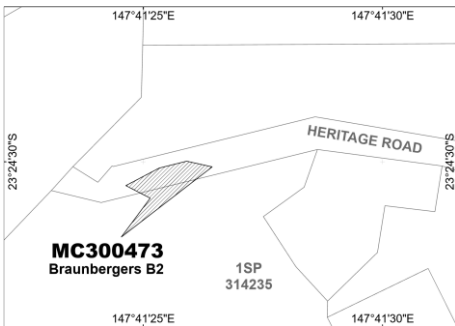

Nature of Act(s): The grant of a Mining Claim under the *Mineral Resources Act 1989* (Qld) authorises the holder to mine and carry out associated activities subject to the *Mineral Resources Act 1989* (Qld) for a term not exceeding ten (10) years, with the possibility of renewals for terms not exceeding ten (10) years.

Name and address of person doing Act(s): It is proposed that the Mining Claims be granted subject to the provisions of the *Mineral Resources Act 1989* (Qld) by the Queensland Minister for Resources, PO Box 15216, City East, Queensland, 4002.

Native Title Parties: Under the *Native Title Act 1993* (Cth) any person who is a "native title party" is entitled to certain rights in relation to the proposed grant of a Mining Claim. Under section 30 of the *Native Title Act 1993* (Cth), persons have until three (3) months after the Notification Day to take certain steps to become native title parties in relation to this notice. Enquiries in relation to filing a native title determination application may be directed to the Federal Court, Brisbane Registry, Level 6, Harry Gibbs Commonwealth Law Courts Building, 119 North Quay, Brisbane, Queensland, 4000. Telephone: 1300 720 980 or Email: nativetitleQLD@fedcourt.gov.au. Enquiries in relation to the registration of a native title determination application may be directed to the National Native Title Tribunal, Brisbane Registry, Level 5, Harry Gibbs Commonwealth Law Courts Building, 119 North Quay, Brisbane, Queensland, 4000. Telephone: (07) 3052 4040.

Further information: May be obtained from the Department of Resources, Mining Registrar, Small Scale Mining Hub, PO Box 275, Emerald, Queensland, 4720. Telephone: (07) 3078 3031 or Email: SSMHub@resources.qld.gov.au

Notification Day: 13 DECEMBER 2023

Dated 16 November 2023

Signed:
Executive Director,
for Minister for Resources.



**Queensland
Government**